

# LAMPSONE

## 6" IC LED DEDICATED CAN NEW CONSTRUCTION SHALLOW HOUSING

ITEM #:

**A7/LED/SH**

**DESCRIPTION:**

Is designed for new construction installations and suitable for use in ceiling where the housing can be direct contact with insulation. For use in shallow ceiling which have tighter clearances.

**PLASTER FRAME:**

- Galvanized steel construction. The housing can be removed from plaster frame to provide access to the junction box.

**JUNCTION BOX:**

- Listed for through branch circuit wiring.
- Contains one 1-1/8", six 7/8" knockouts and four Romex pryouts with strain relief.

**BAR HANGER:**

- Pre-installed real nail easily installs in regular lumber, engineered lumber.
- Bar Hangers are adjustable from 13-5/8" to 25" and can be repositioned 90 degree on plaster frame.

**LISTINGS:**

- cUL Listed for Damp Location
- cUL Listed for Feed Through
- Certified under ASTM-E283 for Air Tight construction.

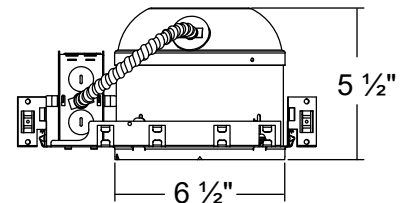
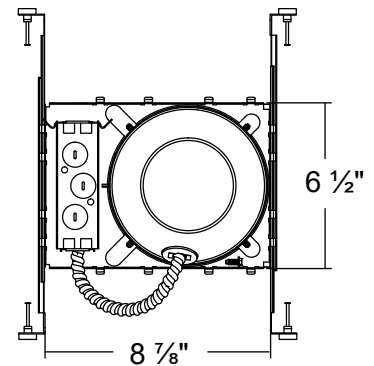

Project:	
Contact:	
Location:	
Fixture Type:	

Quantity	Notes